

PRIMING AND FILLING AN EMPTY CIS

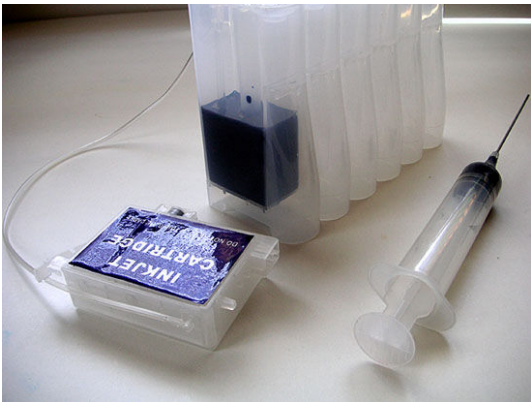

1) Fill an ink tank at least 1/3 full of ink.



5) As you pull air out the cartridge will start to fill with ink.

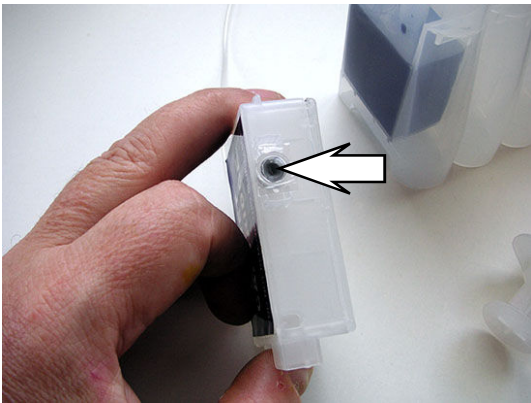

2) Turn the cartridges upside down and pierce the film cover on the ink outlet hole.

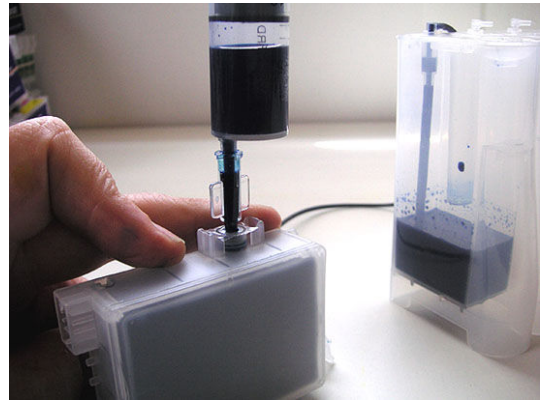

6) Ink will fill the tank and flow into the syringe, allow 2cm of ink into the syringe.



3) Firmly fit the supplied clear acrylic end adaptor to the syringe as shown.

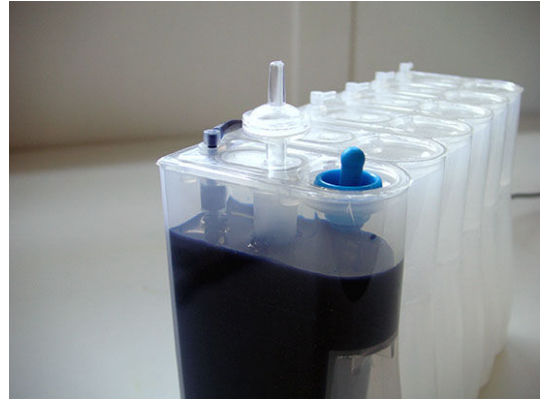

7) Empty ink from syringe into ink tank and top up tank with ink. Leave a 1.5 cm gap at top. Fit front rubber plug to tank and air filter as shown. Repeat process for other colours.

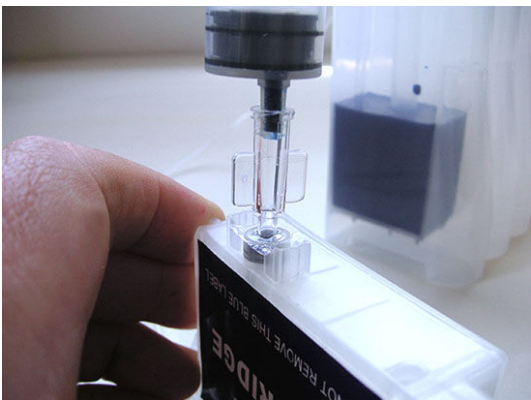

4) Close up the syringe and insert the adaptor into the ink outlet hole as far as it will go. Open up the syringe and air will be removed from the cartridge.

When you have completed the above process with all colours you can then install your CIS as per the installation instructions.

Please remember that having installed your CIS and carried out a nozzle check it can take up to 24 hours for the system to settle down and give a 100% perfect nozzle check.

Whilst 90% of units work perfectly immediately after installation it can take 24hrs for small bubbles of air in the ink to dissipate.